

# Rancho Murieta CSD

FISCAL YEAR 2020–21

PROPOSED BUDGET PRESENTATION

CAPITAL IMPROVEMENT

CAPITAL REPLACEMENT

PLANS

MAY 20, 2020

---

**Rancho Murieta**  
Community Services District  
*Serving the community for over 30 years.*



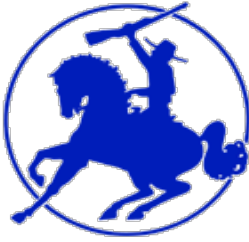

# CIP #1

## PROJECT TITLE: MURIETA VILLAGE DISTRIBUTION SYSTEM – REPLACEMENT

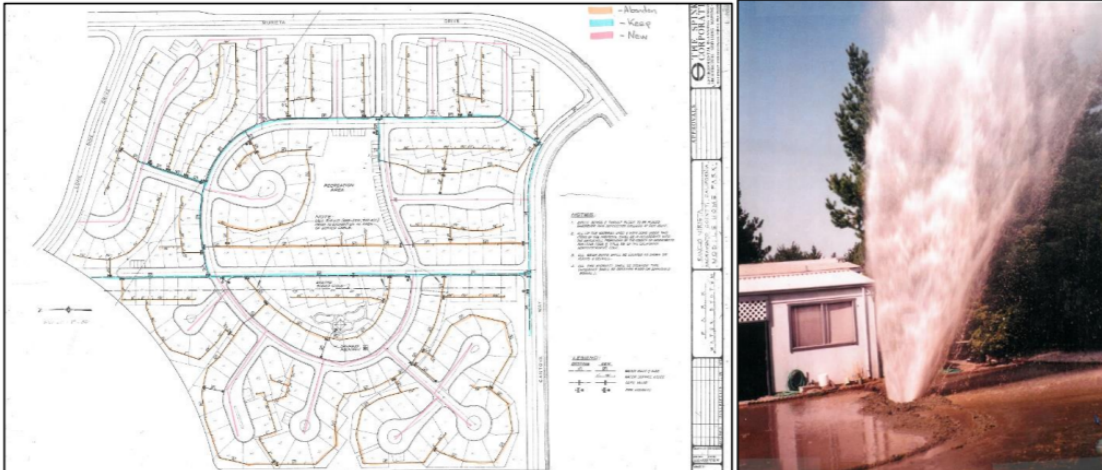

<b>CAPITAL PLAN</b>	Water – Replacement Reserves
<b>CRP #</b>	21-01-1
<b>PROJECT BASIS:</b>	Replace aging schedule 40 PVC water infrastructure running under Murieta Village residential units.
<b>DESCRIPTION:</b>	Route new water distribution system within streets and Murieta Village right of ways that avoid running under the units within the Murieta Village. Provide new piping system for long term viability of water supply to the Murieta village and an increased level of safety for the residents of the Village by abandoning nearly 50 year old PVC water mains that run under residential units. Project aims to avoid potential liability to the District and its rate payers from potential claims should distribution system break under residential units within the Murieta Village.
<b>ENVIRONMENTAL OR REGULATORY ISSUES:</b>	This project would require a filing of a Notice of Exemption-public right-of-way.
<b>RISK ASSESSMENT:</b>	High.
<b>PROJECT BUDGET:</b>	\$877,000
<b>BASIS OF COST EST:</b>	Estimates for engineering design, bidding, contractor, material, project management, and outreach.

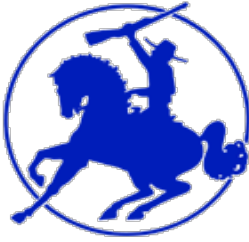

# CIP #2

**PROJECT TITLE: WATER TREATMENT PLANT CHLORINE GAS TO BLEACH  
CONVERSION - IMPROVEMENT FUND**



*Ton cylinders of chlorine gas*

<b>CAPITAL PLAN</b>	Water Improvement Reserves
<b>CIP #</b>	21-02-1
<b>PROJECT BASIS:</b>	System Conversion to bleach for water disinfection
<b>DESCRIPTION:</b>	Eliminate the use of chlorine gas at the Water Plant for potable water disinfection by converting to using industrial strength sodium hypochlorite (bleach).
<b>REGULATORY ISSUES:</b>	Safer product for staff; Substantially less regulatory oversight and required staff training; Mitigates risk to community from transport, storage and use of chlorine gas. Filing of a Management of Change with Sacramento County Environmental Management Department will be required.
<b>RISK ASSESSMENT:</b>	Provides a safer alternative for the neighboring community vs the potential of a catastrophic chlorine gas leak and chlorine gas deliveries through community and neighboring roadways.
<b>PROJECT BUDGET:</b>	\$352,940 (2017 figure)
<b>BASIS OF COST EST:</b>	Cost estimates are from the 2017 Coastland Capital Improvement fee study, based on removal of gas feed system, procurement and installation of chemical feed skids for bleach injection; engineering for design, plans, bid packet, submittal review and as-builts; contractor procurement and placement of tanks, building tank pads, and installing piping and feed equipment appurtenances. <a href="https://www.ranchomurieta.com/files/c82d2d87d/agenda+11+c+Ord+2017-02+Fee+Study+Report+%28Final+110817%29.pdf">https://www.ranchomurieta.com/files/c82d2d87d/agenda+11+c+Ord+2017-02+Fee+Study+Report+%28Final+110817%29.pdf</a>

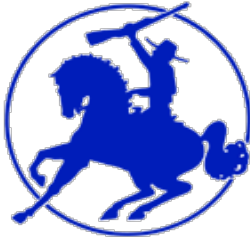

# CIP #3

## PROJECT TITLE: RIO OSO PUMP STATION GENERATOR – REPLACEMENT



<b>CAPITAL PLAN</b>	Water – Replacement Reserves
<b>CRP #</b>	21-03-1
<b>PROJECT BASIS:</b>	Replace existing 1980 tier 0 generator with a tier 4 diesel or propane generator to comply with California air quality standards as well as to provide reliable back-up power at this critical pump station.
<b>DESCRIPTION:</b>	The Rio Oso booster pump station provides continuous pumping of water to meet the water pressure and supply demands of Units 3, 3b, and 4 in the North. The generator and electrical switchgear there allow the station to continue to operate in the event of power outages.
<b>ENVIRONMENTAL OR REGULATORY ISSUES:</b>	No issues, simple updating of air quality permit for site.
<b>RISK ASSESSMENT:</b>	Medium
<b>PROJECT BUDGET:</b>	\$65,000 estimated
<b>BASIS OF COST EST:</b>	Budgetary estimate from generator vendor, estimate for electrical services for disconnects and connections.

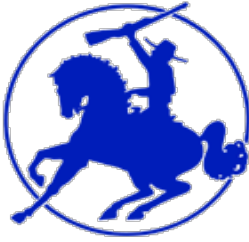

# CIP #4

**PROJECT TITLE: RIO OSO PUMP STATION VFD PANEL – CAPITAL REPLACEMENT**



<b>CAPITAL PLAN</b>	Water – Replacement Reserves
<b>CRP #</b>	21-04-1
<b>PROJECT BASIS:</b>	Replace 1994 variable frequency drives (VFDs) and appurtenances that modulate power to the booster pumps to maintain water pressure. Replacements would ensure long term reliability at this critical site that cannot experience any failure.
<b>DESCRIPTION:</b>	The Rio Oso booster pump station provides continuous pumping of water to meet the water pressure and supply demands of Units 3, 3b, and 4 in the North. The VFDs control the speed of the booster pumps by modulating power to the pump motors through feedback from a pressure gauge and the sites programmable logic controller (PLC).
<b>ENVIRONMENTAL OR REGULATORY ISSUES:</b>	No issues, simple updating of air quality permit for site.
<b>RISK ASSESSMENT:</b>	Medium
<b>PROJECT BUDGET:</b>	\$60,000 estimated
<b>BASIS OF COST EST:</b>	Budgetary estimate from generator vendor, estimate for electrical services for disconnects and connections.

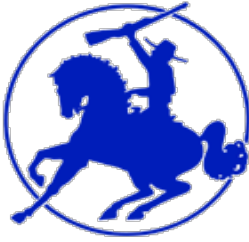

# CIP #5

---

## PROJECT TITLE: WATER PLANT COMPRESSORS – CAPITAL REPLACEMENT



<b>CAPITAL PLAN</b>	Water – Replacement Reserves
<b>CRP #</b>	21-05-1
<b>PROJECT BASIS:</b>	Replace two compressors that were installed in 2015 as part of the water treatment plant expansion. Since that time the compressors have sustained damage from chemical vapors present within the room in which they reside. A separate room will be created for them to prevent this from happening again.
<b>DESCRIPTION:</b>	These compressors supply air to various pneumatic valves and the membranes for integrity testing.
<b>ENVIRONMENTAL OR REGULATORY ISSUES:</b>	None
<b>RISK ASSESSMENT:</b>	Medium
<b>PROJECT BUDGET:</b>	\$25,000 estimated
<b>BASIS OF COST EST:</b>	Budgetary estimate from vendors.

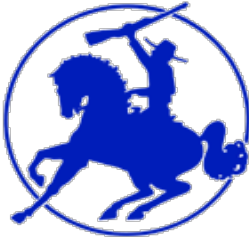

# CIP #6

## PROJECT TITLE: WATER METER REPLACEMENTS, COMMERCIAL, UNIT 1 & UNIT 2 – CAPITAL REPLACEMENT



Old

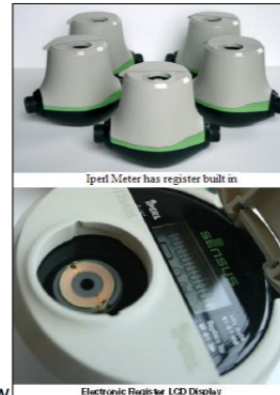

New

### CAPITAL PLAN

Water – Replacement Reserves

### CRP #

21-06-1

### PROJECT BASIS:

Replace 275 older water meters with mechanically moving parts, which are at the end of their intended life cycle, with new solid-state electromagnetic water meters.

### DESCRIPTION:

Water meters track the water usage which is used for billing at the usage rate and for water accounting. Meters with mechanical parts wear out over time and loose accuracy until complete failures bring them to staff's attention. Proactively searching out the older mechanical meters based on their serial numbers that are tracked in the billing system, will allow the District to replace these older meters sooner. This will result in a more accurate account of water being used through the new meters and therefore a slight increase in revenue and more accurate water use data for the District showing less water loss. The new meters also have built in data tracking that may be downloaded by staff utilizing existing vendor software, and a 10 year full rated warranty, with another 10 year pro-rated warranty.

### ENVIRONMENTAL OR REGULATORY ISSUES:

None

### RISK ASSESSMENT:

Low

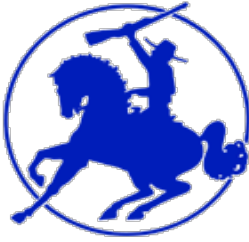

# CIP #6 (cont'd)

**PROJECT BUDGET:** \$60,000 estimated

**BASIS OF COST EST:** Current cost from vendor and meters amounts. Costs do not factor in District staff time, only material costs.

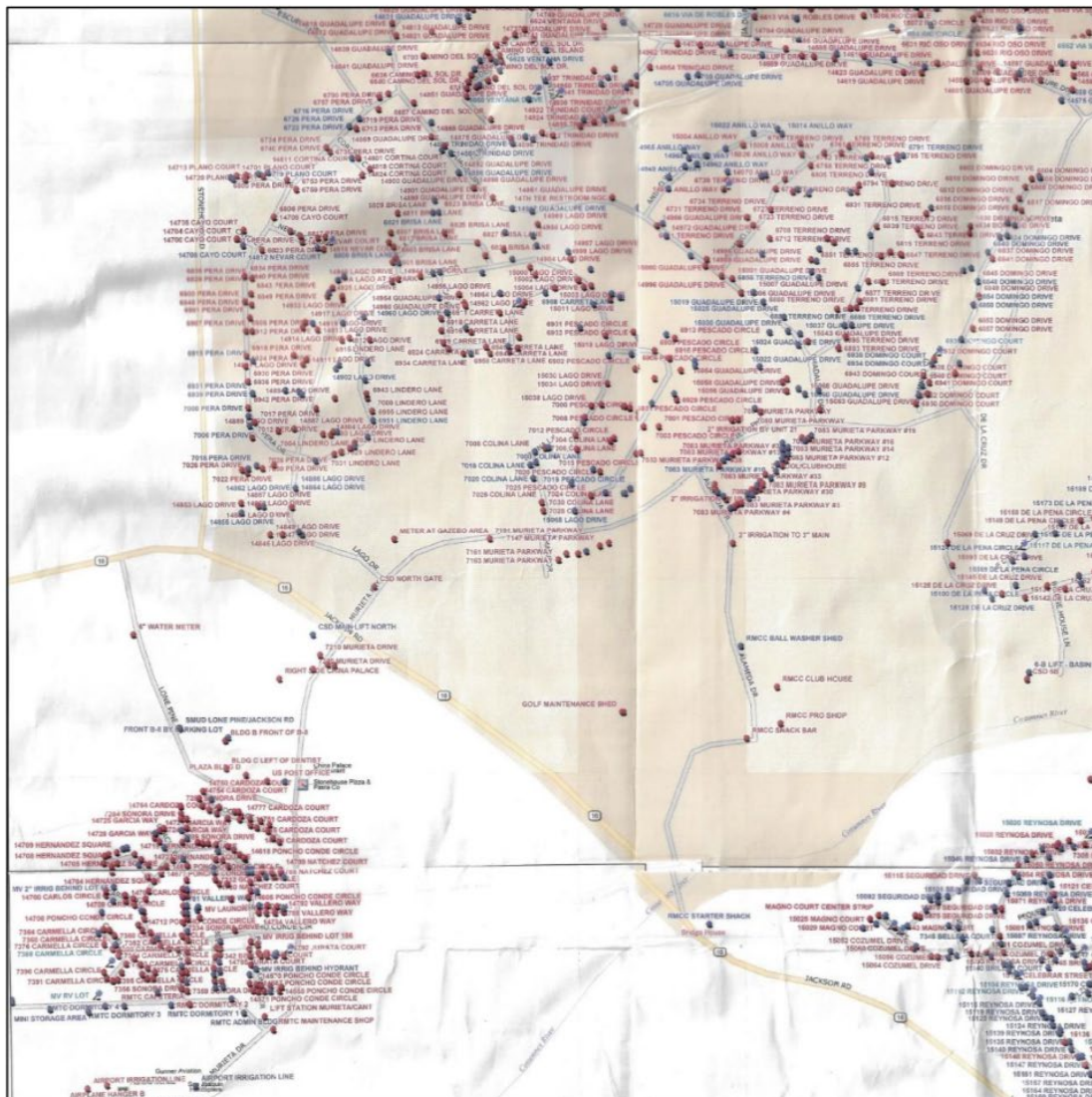

Example of water meter locations throughout District



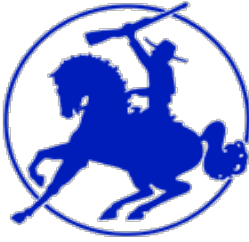

# CIP # 7

## PROJECT TITLE: GRANLEES DIVERSION INTAKE – CAPITAL REPLACEMENT

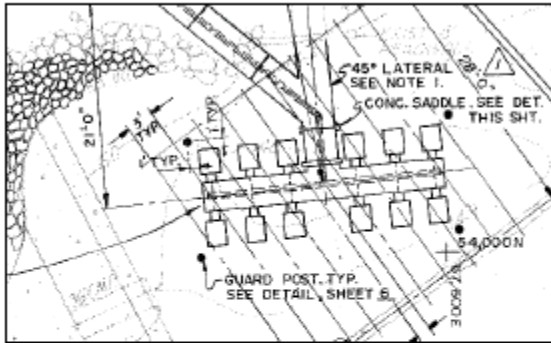

<b>CAPITAL PLAN</b>	Water – Replacement Reserves
<b>CRP #</b>	21-07-1
<b>PROJECT BASIS:</b>	Replace potentially failing components as a pro-active step towards preventing future failures that could delay the District from diverting river water to our storage reservoirs.
<b>DESCRIPTION:</b>	The intake system is located on the north side of the Cosumnes River. It is used to draw water from the Cosumnes river for the community's potable water storage. For this project we would evaluate intake piping, screening, and compressor and air piping that is utilized for backflushing the screens, and replace any necessary components to prolong the life of the water intake system.
<b>ENVIRONMENTAL OR REGULATORY ISSUES:</b>	None
<b>RISK ASSESSMENT:</b>	Medium
<b>PROJECT BUDGET:</b>	\$85,000 estimated
<b>BASIS OF COST EST:</b>	Stainless steel fasteners, piping, compressor for backflushing, and possible pipe repairs. If pipe replacement is needed, cost will be significantly higher, therefore two costs are shown.

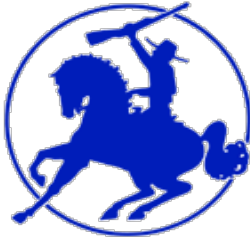

# CIP # 8

**PROJECT TITLE: MAIN LIFT NORTH SEWER PUMP STATION GENERATOR – REPLACEMENT**



<b>CAPITAL PLAN</b>	Sewer – Replacement Reserves
<b>CRP #</b>	21-08-2
<b>PROJECT BASIS:</b>	Replace existing tier 0, 338 HP generator with a tier 3 diesel or propane generator to comply with California air quality standards as well as to provide reliable back-up power at this critical sewer pump station.
<b>DESCRIPTION:</b>	The Main Lift North sewer pump station is the largest sewer pumping station in the District. It collects and pumps sewer from Units 1, 2, 3, 3b, and 4 in the North and all commercial and Murieta Village areas south of Highway 16 north of the river. The generator and electrical switchgear there allow the station to continue to operate in the event of power outages.
<b>ENVIRONMENTAL OR REGULATORY ISSUES:</b>	Updating of air quality permit for site required. Site power is shared with Sacramento Metro Fire Station 59 under an agreement and will need coordination with them.
<b>RISK ASSESSMENT:</b>	Medium
<b>PROJECT BUDGET:</b>	\$125,000 estimated
<b>BASIS OF COST EST:</b>	Budgetary estimate from generator vendor, for a fixed tier 3 generator, transfer switch, start-up and testing.

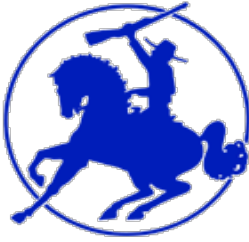

# CIP # 9

**PROJECT TITLE: SECURITY LICENSE PLATE READER REPLACEMENT**



**CAPITAL PLAN**

Security Reserves

**CRP #**

21-09-03

**PROJECT BASIS:**

Upgrade the existing North Gate License Plate Reader (LPR) management system to new system with increased storage and additional capabilities.

**DESCRIPTION:**

Currently the LPR camera systems at the North Gate record and save video for approximately 25-30 days. We will upgrade the system to add capacity to allow for 90-day storage of video. The current system is also near end of life and no longer reliable.

**ENVIRONMENTAL OR REGULATORY ISSUES:**

None

**RISK ASSESSMENT:**

Low

**PROJECT BUDGET:**

\$3,500.00 estimated

**BASIS OF COST EST:**

Budgetary estimate from camera vendor

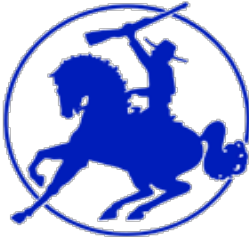

# CIP # 10

---

**PROJECT TITLE: SECURITY CAMERA STORAGE REPLACEMENT**



**CAPITAL PLAN**

Security Reserves

**CRP #**

21-10-03

**PROJECT BASIS:**

Replace existing gate camera memory systems to longer term memory.

**DESCRIPTION:**

Currently the camera systems at the North and South Gates record and save video for approximately 25-30 days. We will upgrade the hard drive memory systems so we will get 90-day storage of video. The current memory storage is also aged and not reliable.

**ENVIRONMENTAL OR REGULATORY ISSUES:**

None

**RISK ASSESSMENT:**

Low

**PROJECT BUDGET:**

\$18,000.00 estimated

**BASIS OF COST EST:**

Budgetary estimate from camera vendor

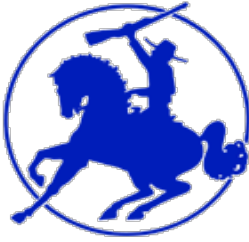

# CIP # 11

## FINANCIAL SYSTEM REPLACEMENT RFP – ADMIN REPLACEMENT RESERVES



<b>CAPITAL PLAN</b>	Administrative Replacement Reserves
<b>CRP #</b>	21-11-4
<b>PROJECT BASIS:</b>	Replace.
<b>DESCRIPTION:</b>	<p>The reasons why it is time for the District to move to a new ERP system:</p> <ul style="list-style-type: none"><li>• The District has been using Dynamics GP since 1995 and outgrown its capacity. Staff often find themselves wrestling with bottlenecks and complications with the system.</li><li>• Dynamics GP does not have specific module to handle fund accounting which is much needed by the District.</li><li>• Dynamics GP does not offer a fully cloud-based business solution.</li><li>• There has been a lot of controversy surrounding the future of Dynamics GP for the Public Sector.</li><li>• Dynamics GP is losing its robust partner ecosystem. The pool of partners and the Dynamics professionals is set to shrink as GP professionals retire or move on to products which have a longer shelf-life</li></ul>
<b>ENVIRONMENTAL REGULATORY ISSUES:</b>	None
<b>RISK ASSESSMENT:</b>	Medium
<b>PROJECT BUDGET:</b>	\$25,000 estimated
<b>BASIS OF COST EST:</b>	Budgetary estimate from vendors